

CRPF PUBLIC SCHOOL, ROHINI

First Intra School Mathematics Olympiad 2010

CLASS IV

Max. Marks: 60

Time: 1 hour 30 minutes

General Instructions:

1. Each question of Section A (Q1-5) carries 2 marks, that of Section B (Q6-15) carries 3 marks and of Section C (Q16-20) carries 4 marks.
 2. Each question has five choices (A, B, C, D or E). Select the correct answer to each question and darken the corresponding circle in the Answer Sheet provided to you. For each correct answer in section A, B and C, two, three and four marks will be awarded respectively. **One mark will be deducted for each incorrect answer (of all the sections), while no mark will be deducted for any unattempted question.** Darkening of more than one circle for any answer shall bear zero mark.
 3. Darken the correct circle with HB Pencil ONLY.
 4. Do not make any stray marks on the answer sheet and do not use it for any kind of Rough Work.
-

SECTION - A

Q1) An odd number is

- (A) a number which can be divided by 3 (B) a number which can be divided by 2
(C) a number which cannot be divided by 2 (D) a number which cannot be divided by 3
(E) a number which can be divided by 10

Q2) Digit 3 in the fraction $\frac{3}{5}$ is its

- (A) Numerator (B) Denominator (C) Operator (D) Dictator (E) Product

Q3) Amitabh Bachchan in the film Deewar carried a badge having the number 786. How many tens are there in this number?

- (A) 7 (B) 6 (C) 8 (D) 0 (E) 1

Q4) The result of multiplying a number by another is called as

- (A) Resultant (B) Multitude (C) Multiple (D) Product (E) Factor

Q5) A regular pentagon has

- (A) Two parallel sides (B) Four parallel sides (C) No parallel sides
(D) At least two parallel sides (E) Three parallel sides

SECTION - B

Q6) A piece of chalk is 3 centimetre long. How many such pieces put end to end would be needed to cover the boundary of a rectangle field that is 100 metres long and 50 metres wide?

- (A) 10,000 (B) 1000 (C) 100 (D) 300 (E) 3000

Q7) If the sides of square B are two times those of square A then the area of square B would be

- (A) Same as that of square A (B) Two times that of square A
(C) Three times that of square A (D) Four times of square A
(E) Eight times that of square A

Q8) Aryan, Ajeet and Bipen are three friends. They supply vegetables, fruits and chicken respectively to a big hotel. Aryan visits hotel every 2nd day, Ajeet visit hotel every 3rd day and Bipen comes every 5th day. All of them met on 1st October. When would they all meet again?

- (A) 31st October (B) 30th October (C) 10th October (D) 11th October (E) 15th October

Q9) There is a pole in the lake in adventure Island. 1.5 metre pole is underground and another 0.5 metre pole is below the surface of water. What is seen above the water is 5 metres long pole. What is the overall length of that pole?

- (A) 25 metre (B) 20 metre (C) 115 metre (D) 6 metre (E) 7 metre

Q10) On the first day in an activity class, teacher instructed that every student should introduce himself/herself to every other student and shake hands. If there were total of 8 students in the class how many total handshakes would be there?

- (A) 8 (B) 16 (C) 7 (D) 28 (E) 32

Q11) Prime numbers are those numbers that can be divided only by themselves and number 1. Which is the largest two digit prime numbers whose digits are also prime numbers ?

- (A) 71 (B) 89 (C) 73 (D) 77 (E) 97

Q12) Find out next number in the sequence

0, 1, 1, 2, 3, 5, 8, 13, 21, 34, _____, _____

- (A) 55,89 (B) 45,63 (C) 41,52 (D) 45,76 (E) 59,75

Q13) Following is the figure composed of congruent squares. How many rectangles can be traced in the figure?

- (A) 3 (B) 7 (C) 14 (D) 6 (E) 10

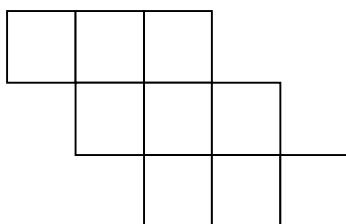

Q14) Sunita buys cool drink powder from the market. The instructions on the packet tell her that 2 cups of powder should be mixed with 7 cups of water to 9 cups of drink. If she drinks 1 cup, how much powder and how much water has she used?

(C) $\frac{3}{7}$ powder $\frac{4}{7}$ water
 (D) $\frac{1}{5}$ powder $\frac{4}{5}$ water

(B) $\frac{1}{9}$ powder $\frac{8}{9}$ water (C) $\frac{2}{7}$ powder $\frac{5}{7}$ water
 (E) $\frac{2}{9}$ powder $\frac{7}{9}$ water

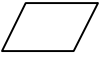
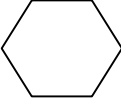
Q15) How many  are in 

(A) 3

(B) 4

(C) 6

(C) 2

(E) 8

SECTION - C

Q16) The number of cubical boxes each side of which is 2 metres long that can be accommodated in a room 10m long, 10m wide and 8m high would be

(A) 8

(B) 20

(C) 800

(D) 100

(E) 40

Q17) Nikita is selecting fool tiles for her room in her family's new house. No tiles will be put down in the closets. Each tile is of 1sq. metre and cost Rs.7. how much will the tiles cost if whole floor is to be covered with tiles?

(A) Rs. 176

(B) Rs. 1332

(C) Rs. 1200

(D) Rs. 120

(E)Rs. 1076

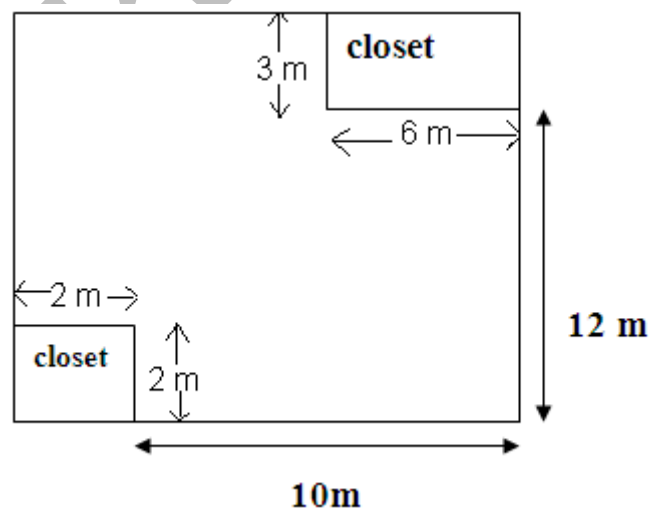

Q18) The weight of a glass bowl and marbles it contains is 500 grams. If the number of marbles in the bowl is doubled, the total weight of bowl and marbles is 920 grams. What is the weight of the bowl?

(A) 80 grams

(B) 420 grams

(C) 480 grams

(D) 500 grams

(E)100 grams

Q19) The diagram shows the floor plan for the eight apartments on each floor of building having four floors. On second floor apartment no. 9 is directly over apartment no. 1, apartment no. 10 is directly over apartment no. 2 and so forth.

Mahir lives in apartment no. 4. Anil lives on the 4th floor in the apartment which is exactly above the Mahir's apartment. What is Anil's apartment number?

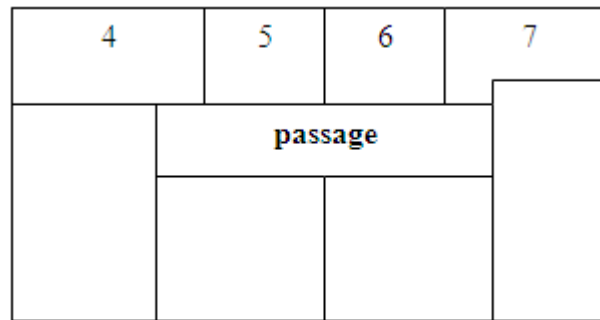

- (A) 20 (B) 24 (C) 36 (D) 30 (E) 28

Q20) Yash has less than 30 marbles. When he groups them in piles of 3, then no marble is left over. When he put them in piles of 2, then 1 marble is left. When he puts them in piles of 5, 1 marble is left. How many marbles does he have?

- (A) 27 (B) 28 (C) 19 (D) 21 (E) 29

NOTE: The **answer key** of this question paper will be available on the School's blog www.crpfsrohini.blogspot.com on November 11, 2010 after 6 pm. The **Result** will be declared on 19 November and will also be available on the school's blog.